

# Briarcliff Baptist Church

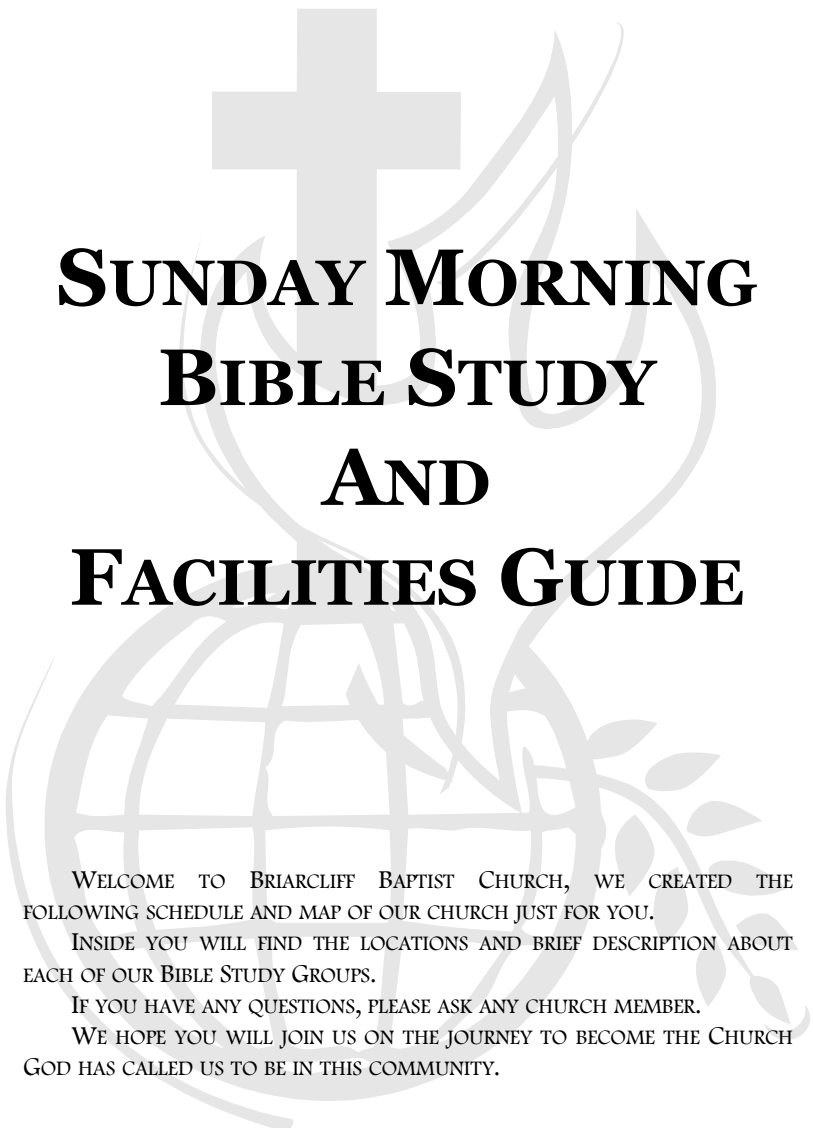

## **SUNDAY MORNING BIBLE STUDY AND FACILITIES GUIDE**

WELCOME TO BRIARCLIFF BAPTIST CHURCH, WE CREATED THE FOLLOWING SCHEDULE AND MAP OF OUR CHURCH JUST FOR YOU.

INSIDE YOU WILL FIND THE LOCATIONS AND BRIEF DESCRIPTION ABOUT EACH OF OUR BIBLE STUDY GROUPS.

IF YOU HAVE ANY QUESTIONS, PLEASE ASK ANY CHURCH MEMBER.

WE HOPE YOU WILL JOIN US ON THE JOURNEY TO BECOME THE CHURCH GOD HAS CALLED US TO BE IN THIS COMMUNITY.

### OUR CHURCH PURPOSE

To actively proclaim the way of salvation and to nurture a community of faith through worship, evangelism, education and ministry in the name of Christ.

## SUNDAY MORNING SCHEDULE

*8:45 - 9:30 a.m. — Chapel Open For Prayer*

*9:30 - 10:45 a.m. — Church Library Open*

*9:45 - 11:00 a.m. — Bible Study*

*11:00 a.m. — Morning Worship*

## 9:45 A.M. BIBLE STUDY

<u>CLASS</u>	<u>LOCATION</u>
<b>PRESCHOOL</b>	
INFANTS	ROOM 222
PRESCHOOL	ROOM 220
<b>CHILDREN</b>	
KINDERGARTEN/GRADES 1-2	ROOM 219
GRADES 3-5	ROOM 217
<b>YOUTH</b>	
GRADES 6-12	ROOM 308
<b>ADULT DIVISION I</b>	
YOUNG ADULTS	COED (AGE 18-30) ROOM 112 & 114
CORNERSTONE	COED (35-UP) ROOM 123
<b>ADULT DIVISION II</b>	
CLOSER WALK	COED (50-UP) ROOM 113 & 115
D.M.A.	WOMEN (30-UP) ROOM 133
JOYFUL	WOMEN (55-UP, SINGLE WIDOWED, DIVORCED) ROOM 203

**ADULT DIVISION III**

**BYKOTA**

**WOMEN (60-UP)**

**ROOM 201**

**CORBETT HADEN**

**MEN (75-UP)**

**ROOM 125**

**GOODWILL/KEENAGERS**

**MEN (80-UP)**

**ROOM 207**

**MARY-MARTHA**

**WOMEN (70-UP)**

**ROOM 208**

**P.A.L.**

**WOMEN (70-UP)**

**ROOM 209**

**TWO-SEEK**

**COED (60-UP)**

**ROOM 216**

**ADULTS**

**“ELECTIVE”**

**WORSHIP WELCOME CENTER**

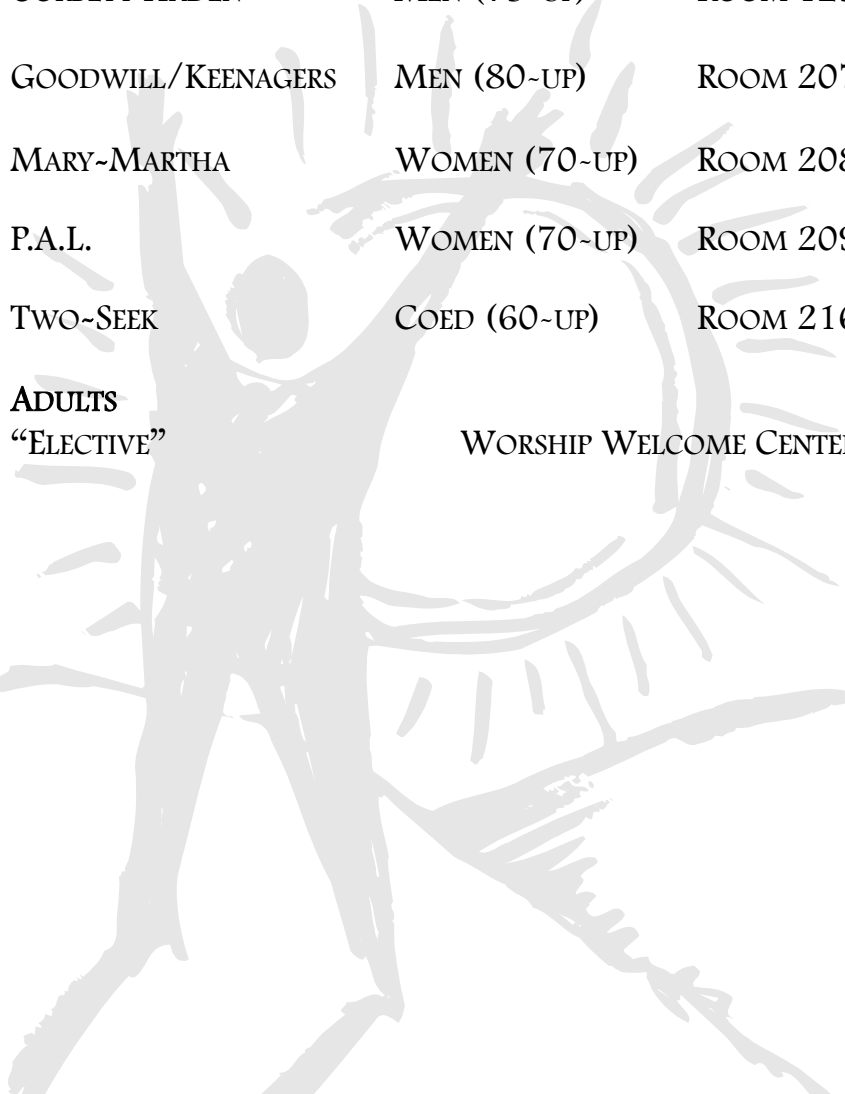

**Show Me Your Ways,  
O Lord, Teach Me Your Paths...  
Psalm 25:4**

# SECOND FLOOR MAP

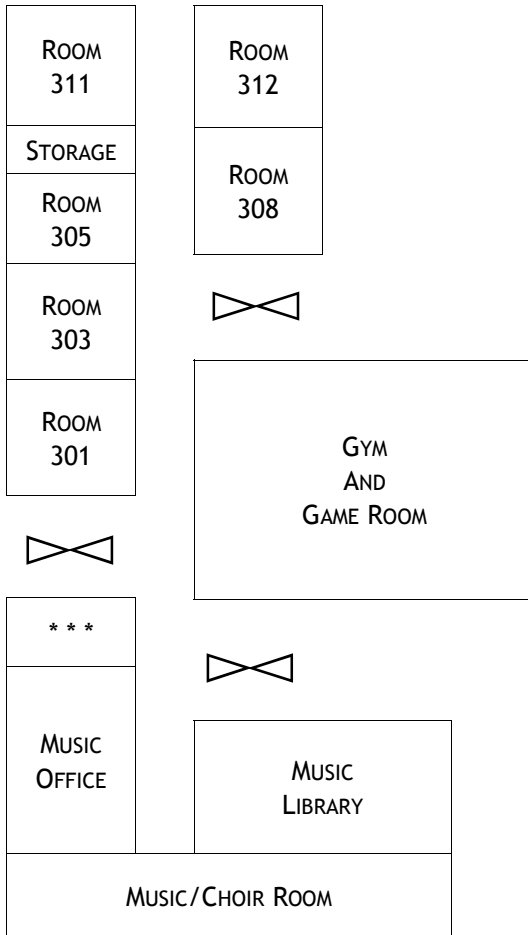

## SECOND FLOOR ROOM ASSIGNMENTS

301 Youth	305 Vacant	311 Choir Room
303 Handbells	308 Youth	312 Vacant



ROOM 116	ROOM 114
-------------	-------------

ROOM 125
ROOM 129
ROOM 131
ROOM 133

*	ROOM 123	ROOM 121	ROOM 117	ROOM 115
---	-------------	-------------	-------------	-------------

BASEMENT ROOM ASSIGNMENTS	
112 Young Adults	121 Clothes Closet
113 Closer Walk	123 Cornerstone
114 Young Adults	125 Corbett Haden
115 Closer Walk	129 Clothes Closet
116 Storage	131 Ceramics
117 Clothes Closet	133 D.M.A.

# BASEMENT MAP

# FIRST FLOOR MAP

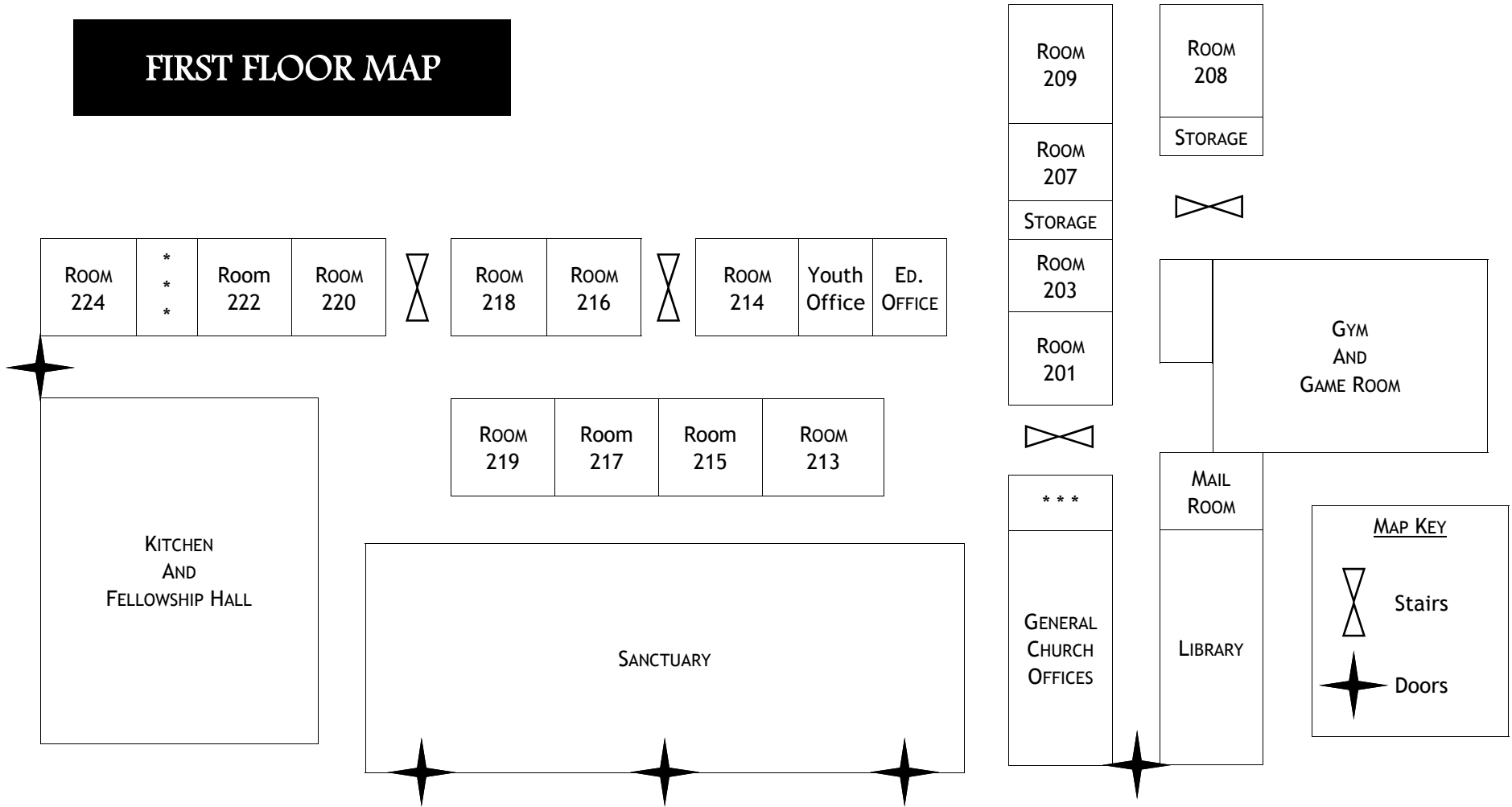

FIRST FLOOR ROOM ASSIGNMENTS				
201 BYKOTA Class	208 Mary Martha Class	214 Children's	217 Children's	220 Preschool Room
203 Joyful Class	209 P.A.L. Class	215 Resource Room	218 Children's	222 Infant Room
207 Goodwill/Keenagers Class	213 Children's	216 Two Seek Class	219 Children's	224 Infant Room
*** FOR RESTROOMS (Male and Female)				

# SUNDAY MORNING LEADERSHIP

Bill Bigger, Pastor

Liz Pearson, Minister of Education

Ginny Dempsey, Minister of Youth and Children

Carey Huddlestun, Minister of Music

Cindy Marshall, Church Organist

Bill Bullard  
Sunday School Director

---

## HOW TO JOIN BRIARCLIFF BAPTIST CHURCH

*Perhaps Briarcliff Baptist Church is the kind of church you have been looking for and would like to join but don't know how. Here are the ways you can join this church:*

1. ***By profession of faith*** - Upon accepting Christ as your personal savior, you make public your faith by coming to be baptized and received into the church.
2. ***By letter*** - If you are a member of another Baptist Church, you come by telling us of your decision to join Briarcliff Baptist, and we will write that church asking for your letter of membership.
3. ***By statement*** - If you have been saved, experienced believer's baptism by immersion, identified with the church but a request for a letter of membership cannot be made, you come by indicating your situation to the pastor and request membership by statement.
4. ***From another denomination*** - You come and share your situation with the pastor who will explain to you whether you will be presented for membership by statement or baptism.